

THE GOLD NUGGET

September 2011



The Prez Sez by Jim Long

The August meeting featured a Slide presentation on 'The Red Dog Placer Claim' put on by Membership Committee member Greg Davis. What a great job that was. Greg has offered to take anyone from the Club to his Claim in California as he is planning to be there around the first of September. I understand that there is some interest from a half dozen or so people who would like to go. I hope everyone has a good time and finds lots of that 'yaller' gold.

Wow...!! Gold has now topped the 1900 dollar barrier for the first time in history. But as I said, there is a school of thought out there that says the market will eventually crash and the price will plummet. The price of gold is being driven by the fact that the American dollar is severely weakened and the world economy is also shaky. So much so that people are willing to buy at these high prices believing that it will go even higher and that at least their dollar is safe in gold. I don't know. I personally prefer to buy low and sell high myself.

The high water is finally gone and most of us have been in the lower creeks since about the 8th of August. I am finding that the extended high water period has sure replenished the gold that has been concentrated in the lower watersheds. Clear Creek continues to be good and we are finding better quantities of gold than we have been used to seeing for some time. As of this date, the Creek is so low that you have to jump up and down just to get your shoes wet.

The Metal Detecting Outing was a success and a number of members showed up to seek treasure. I think just about everyone found something, mostly coins, but some pretty cool jewelry items and other artifacts were found. Terry Weatherly found a pretty neat little ring and I found a silver 'skull' necklace pendant along with several other cool items myself. It was a lot of fun and we will have to do that again next year.

I really enjoyed the Club picnic that was held in Lions Park in Golden. It was quite well attended and I don't think anyone left hungry. Parking was difficult as it turned out to be Golden's Arts Festival as well as the Farmers Market across the street, but we made it work.

I hope everyone has been enjoying some of the Outings that we have put on so far this year. We are trying hard to do things that everyone can participate in and have a lot of fun and develop a little camaraderie. It is not easy to plan and organize an Outing that will be productive and enjoyable for everyone. That is why we try so hard to offer a variety of things to do. I have tried to step up the frequency of doing some of these things. But if any of you have any ideas about Outings or Program subjects, be sure and communicate them to me or any of your Board Members so that we can check it out and see if it is something that we can do.

We will be doing a Panning Demo on September 8, 9, and 10 at the Highlands Ranch Days Festival. This is a 3 day event and we get a lot of exposure for the Club. Then we will be hosting an Outing up in Nederland on September 11 at the Nederland City Park. We will then be going to Idaho Springs on the 17th for a Panning Demo at the Clear Creek Watershed Festival. I hope to see you all at one or more of these events. They should all be a lot of fun.

At the September 21st meeting, I have lined up Glen Godat to speak to us about 'Prospecting and Finding Gold'.

Glen has a lot of years experience in finding gold and has several 3 and 4 ounce nuggets to his credit having used a metal detector. His experience is invaluable and his reputation secure. This should be a good program for everyone.

Anyway, that is how I see it from here. So until we meet again, keep your sunny sides up and may the bottoms of your pans turn bright with that 'Yaller Gold'..!

You may contact me at 303-452-6087 or at jnslong945@msn.com

Happy and safe prospecting!!!

The V.P. Corner by Don Bray

As a person interested in mining activities, I don't have to stress the importance our access to the Public Lands owned by the federal government. This column is the second in a series of columns dealing with issues around our use of these, our Public Lands. The first column in this series appeared in the June issue of "The Golden Nugget"

Survey Systems Used on the Public Lands

The U.S. uses two major but different land survey systems depending on what state you are working in. The original and historic system is referred to as the "Metes and Bounds Survey"

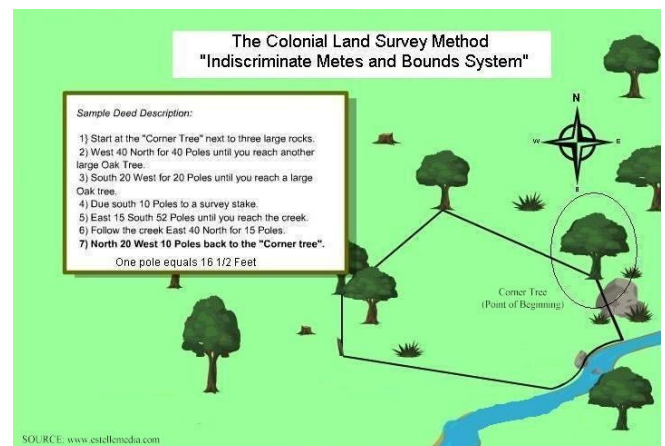



Gold Prospectors of the Rockies Page 2

System” (pronounced: meats and bounds) and was inherited from the Colonial English. It was used in the original thirteen colonies and their western extensions (WV, KY and TN) and continued to be used by the fledgling U.S. Government up until the passage of the “1785 Land Ordinance”. The founding fathers (many land surveyors themselves) recognized how cumbersome and inadequate their existing system was. The “1785 Land Ordinance” was their first attempt to replace the “Metes and Bounds Survey System” (M&B) with a more uniform and rectangular (logical) survey system. This new system established many survey concepts that were later to be used and improved upon in their “Public Lands Survey System” or PLSS, circa 1800, which is still in use today. In this article we shall discuss the M&B survey system.

Today there are twenty states that still use the M&B system. These states are: Connecticut, Delaware, Georgia, Hawaii, Kentucky, Maine, Maryland, Massachusetts, New Hampshire, New Jersey, New York, North Carolina, Pennsylvania, Rhode Island, South Carolina, Tennessee, Texas, Vermont, Virginia, and West Virginia. The remaining thirty, generally western, states all use the newer “Public Lands Survey System”. The main difference between the two systems is that while the PLSS system defines land parcels as generally rectangular and uniform in size and subdivision while with M&B the land parcels are of irregular shape and sizes, “they are what they are.”

The Metes and Bounds Survey System

The term “mete” means to measure or allocate (as in: to mete out punishment), the term “bounds” refers to defining or establishing boundaries (as in: property boundaries). The Old English system of M&B worked well for their conditions: where survey instruments were crude, trained surveyors were few or non-existent, property parcels were small and tightly bounded by existing properties. The English/colonial survey system utilized visible permanent or semi-permanent geographic ground features for property boundary descriptions used in land title documents. These worked well in small tight communities where every one was local and could easily observe the features first hand and where property boundary knowledge could easily pass from generation to generation. However the system falls short when you consider sale and ownership by individuals and companies at long distances, such as across the Atlantic. For an example of M&B survey see the illustration titled “The Colonial Land Survey Method.”

As survey instruments, tools and techniques have improved so have the methods of land descriptions.

Modern metes & bounds surveys and property descriptions no longer rely on geographic ground features but instead rely on “course and call statements” to define the property boundary lines. A course is a statement of angular direction expressed in degrees, minutes and seconds. All course statements begin with North/South directional and end with an East/West directional (such as: S 13 Deg. 29’ 44” W). A course statement is defined as 90 Deg. or less. A call is a statement of distance most often in feet but may also be in rods or chains. A boundary line is defined as a course followed by a call (such as: S 13 Deg. 29’ 44” W, 447 feet).

There are two critical elements required when using M&B surveys and land descriptions. First, the “Point of Beginning” must be clearly identified and defined. Second, the boundary descriptive elements must “close.”

Today metes and bounds are used in the twenty states, listed above, but also to define small land parcels in the PLSS (western states) such as your home’s lot here in Colorado. In the PLSS states on public lands all “lode claims” and many “placer claims” are defined by M&B land descriptions.

To be continued

Contact me at: don_bray@copper.net

From the Ledger of Peg Brozek, Treasurer/Secretary

Thanks to JJ Long, Phil Huff, Joe Johnson and Don Bray for their contributions to the Aug. member only drawings.

This month there will be a total of 7.4 grams with the largest being 2.1 gm. We are still selling blue tickets for that "special nugget". So be prepared to buy extra and good luck to all.

Peg



Board Meeting Minutes From Aug 2011

X	James Long	X	Joe Shubert	X	Joe Fortunato	X	Don Luchtenburg
X	Don Bray		Joe Johnston	X	Terry Weatherly	X	Mike Hurtado
X	Peg Brozek	X	Sue Lemieux	X	Andy Doll		
	Gary Hawley						

Quorum present? Yes

Call to Order: Meeting was called to Order at 6:08 by Jim Long.

Reading and Approval of Minutes: July Minutes were read.

Corrections: None. Approved as read/corrected: Yes

Treasurer's Report: Read by Jim Long.

Questions: None Approved: Yes

Correspondence: Received 7 e-mails and 5 phone calls from within as well as outside the Club. 1 mailing.

Committee Reports: None due.

Webmaster: Andy Doll reports 113,153 hits total on the web site, 1,172 since July meeting.

Unfinished business: Discussed the Club business cards but Mike Hurtado advises he is still working on them. Mike also reports that he has received the Panning Magnets but has not finished them for the store yet. Price for the small and large TBD.

New business: Will try to get Glen Godat for Sept. and Joe Fortunato will put together a slide show of his Alaska trip for Oct.

Planned Outings for 2011: As of this date, the following outings are approved:

Aug 20	<u>Club Picnic, 1100am,</u> at Lions Park in Golden 11am, bring a pot luck item.
Sept 8,9,10	<u>Panning Demo</u> at Highlands Ranch Days conducted by Jim Long
Sept.11	<u>Pan/slucice/dredge Outing</u> in Nederland City Park. Meet at 9am. Organized and led by Greg Davis.
Sept 17	<u>Panning Demo</u> at Clear Creek Watershed Festival in Idaho Springs conducted by Jim Long.
Sept 21	<u>Club Meeting</u> at 7pm.
Sept 24	<u>Georgetown Loop RR ride and Lebanon Silver Mine Tour</u> organized and Led by Sue Lemieux. \$33.00/person for ride and tour 0945am.
Oct 19	<u>Club Meeting</u> at 7pm.
Oct 22	<u>School of Mines Museum Tour</u> in Golden organized and led by Sue Lemieux.

From the Floor: Andy advises that he needs all newsletter submissions by the 1st of month and certainly no later than the 3rd as his time is more limited now with caring for his wife.

Don Bray advises that the IbeX Mine in Leadville is now closed to metal detecting and tailings panning. Newmont Mining is aggressively pursuing violators.

Announcements: Next Board Meeting Sept 21, 2011 at 6:00pm. Next General Meeting Sept 21, 2011 at 7:00pm

Tonight's general meeting program: Power point presentation on 'The Red Dog Claim' in California. Presented by member Greg Davis.

Adjournment: Meeting stands adjourned at 6.50 pm.

QUESTION OF THE MONTH

How much did Tutankhamen's solid gold coffin weigh?

2011 GPR Board of Directors Members

President
James Long
Vice President
Don Bray
Secretary/Treasurer
Peg Brozek
2 Year Board Members
Joe Johnston (2010)
Joe Shubert (2009)
1 Year Board Members
Sue Lemieux
Joe Fortunato
Terry Weatherly
Andy Doll
Don Luchtenburg
Mike Hurtado

General Meeting Minutes From Aug 2011

1. President Jim Long called the meeting to order at 7:06 P.M.



Gold Prospectors of the Rockies Page 4

2. Jim led the membership in the Pledge of Allegiance, to open the meeting.
3. Jim introduced GPR member Greg Davis as the presenter of tonight's program. Greg also presented last month's program on using Local County Online GIS Resources, available on the Internet, for land ownership research. Greg's program, tonight, consisted of an introduction to his California placer gold claim. The claim is on BLM land and has been known as the "Red Dog Placer Mine" since "forty-niner" days. The Red Dog is referenced in the short story titled The Luck of Roaring Camp by Bret Harte, in a derogatory context. The Red Dog is located on the South Fork of the Mokelumne River in Calaveras County, CA near the well known "Roaring Camp" a dude ranch for gold miners.
 - Greg explained how he used the techniques presented in his program last month, to find and research the land ownership in CA while living in Honolulu, HI.
 - Greg showed several pictures of the claim, the river with granite boulders and the access to the claim.
 - Greg then invited the entire GPR membership to "The First Annual Red Dog GPR Outing" at the Red Dog claim the first week in September. Greg said that if you can attend, you can meet up with him any morning that week between 8:00 and 9:00 A.M. in Frank's Café in Mokelumne Hill at the junction of CA highways 26 and 49.
 - A good read on the history of the area is John Doble's Journals and Letters from the Mines.
 - Thanks Greg for another of your programs, well done.
4. Jim announced that today's metal prices were as follows: Gold \$1790.30 per t oz, Silver \$40.29 per t oz, Platinum \$1844.00 per t oz. and Palladium \$783.00 per t oz.
5. Jim announced that this month's website hits total 1172 since the last meeting.
6. Jim introduced Bill Chapman of Golden Detectors in Golden, who was in the audience this evening. Bill announced that he had, as of July 1st, sold the business to Louise Smith, his assistant at the store for the last 7 years. Bill then introduced Louise, also in attendance tonight.
7. Jim advised the membership that the owner of most of the property along North Clear Creek, between the Treatment Plant and the town of Blackhawk, has posted the area with "no trespassing" signs. The only open area to work there is the "Grubstaker" claim, be careful and know where you are working.
8. Jim announced that a consortium of men are trying to establish a metals smelting operation in Clear Creek County. Jim said that they feel that they are about a year away from receiving their permits and plan to be in operation in 2012 or 2013. This will give us small miners a place to get our small quantities of metal containing ores smelted.
9. Jim announced that according to Peg Brozek's Board Meeting Treasurer's Report the club's finances remain in the black. He stated that the club still needs to purchase a little more gold to get through the end of the year. The finances should remain in the black even after that purchase.
10. Jim asks, membership chairman, Greg Davis for his membership report. Greg reported that tonight, we have 101 paid memberships plus 3 new memberships tonight and 71 in attendance including 8 guests. Greg also stated that he would be refunding \$15.00 to some recent new members because they paid a full year's dues in lieu of the required half year's dues due this time of the year.
11. Jim reported that, vice president; Don Bray has learned that the Ibx Mine properties east of Leadville have been posted with "no trespassing" signs by Newmont Mining, owners of the properties. Trespassers are being arrested and are subject to confiscation of their metal detectors and other equipment.
12. Jim called on Sue Clover for her "Question of the Month" which is, "How much gold was used in the construction of the spaceship Columbia?" Sue will collect your answers to this question during the break and distribute a "Club Nugget" drawing ticket to each person turning in a correct answer.
13. Jim announced that Peg Brozek is selling tickets for a 17.1-gram "Members-Only" large nugget drawing during the break. The drawing will be held at a later date.
14. Jim next called on Barbara Barrow to read the first of her cache clues, for she has hidden the new GPR Cache.
15. Jim also stated that the Club Store would be open during the break tonight.
16. Jim asks Sue Lemieux for her announcements. Sue announced that Saturday, Sept. 24th is the trip on the Georgetown Loop Railroad and to the Lebanon Silver mine. The cost for the train ride only is \$25.00 for adults and \$17.00 for children 3-15 years old. For the train ride plus the mine tour (for you must ride the train to get to the mine) the cost is \$32.95 for adults and \$23.95 for children. Plan to be at the Devil's Gate station in Georgetown 9:15 to 9:30 A.M.



Gold Prospectors of the Rockies Page 5

Information and a signup sheet will be on the front table during the break. On Oct. 22nd she is planning a trip to the Colorado School of Mines for a tour of the geology museum.

- Sue announced birthday brownies for those with August birthdays. Five members claimed August birthdays and their brownie awards Joe Johnston, Phil Huff, Gary Hawley, Bill Duncanson and Roy Arkzak.
 - Sue announced that during the break she will auction off some of the Wayne Hale donated books. The minimum bid on each Lot of books is \$1.00 and the minimum bid increments are \$0.25. There will be two lots of two books each, one lot on AZ mining history and one lot on CA mining history.
17. Jim reminded the membership of the planned outings coming up.
- The annual club picnic is this Saturday, August 20th at 11:00 A.M. at Lions Park in Golden. The club will provide meats and drinks while you are asked to bring a side dish to share such as beans, salad, a desert, etc.
 - Sept. 8th, 9th and 10th panning demo at Highlands Ranch, 9:00 A.M. to 1:00 P.M. 5 volunteer's need, maps and signup sheet will be on the front table during the break.
 - Sept. 11th (Sunday) prospecting outing to Nederland City Park 9:00 A.M. to 5:00 P.M. panning, sluicing, highbankers and dredges are all ok.
 - Sept. 17th panning demo at Idaho Springs 9:00 A.M. to 2:00 P.M. 5 volunteers are needed, maps and signup sheet will be on the front table during the break.
 - Sept. 21st next club General Meeting.
 - Sept. 24th the trip on the Georgetown Loop Railroad and to the Lebanon Silver mine. See above.
18. Jim announced the meeting refreshment break, at 8:14. At 8:32 Jim reconvened the meeting.
19. Sue Lemieux announced that the successful bidders in tonight's book auction were Don Bray for the AZ books at \$2.00 and Joe Johnston for the CA books at \$1:00.
20. Jim asked Sue Clover to announce the answer for her "Question of the Month" contest. Sue's correct answer is "1312 t oz. or 40.8 kilograms" she counted any answer 40 to 41 kilos as correct. Twenty people turned in correct answers tonight. Each person with a correct answer received a red nugget drawing ticket.
21. Chuck Cown, Peggy Brozek, and Jim conducted this evening's "Members-Only" and the "Club-Nugget" drawings. For the "Member's-Only" drawing, 7 prizes were awarded to members, our thanks go to all who donated tonight's prizes. Eight nuggets for the "Club-Nugget" drawing were won tonight, the largest being 2.9 gram. The nuggets tonight are from various localities (as noted on the containers).
22. Jim asked for two volunteers to help bring refreshments for the September meeting. Merlene Solis and Don Miner volunteered thanks Merlene and Don.
23. Next meeting is Wednesday, September 21st at 7:00 P.M.
24. Meeting adjourned at 8:50 P.M

Submitted by, Don Bray, Recorder

President Long Conducts Panning/Sluicing Class

On Saturday August 27, President JJ Long hosted another beginners Panning/sluicing Class for newer Club members and prospective members. The Class was well attended by some 18 folks interested in learning the proper techniques for panning and sluicing for gold. The class was conducted in lower Clear Creek at 69th and N. Washington in unincorporated Adams County behind Tymkovich's Meat Market.

The attendees learned how to 'read' a watershed and then how to prepare a gold pan for service, then how to screen your material to make it more manageable. A tub of material was then provided for everyone to practice their panning. A number of the participants were quite surprised to find small pieces of gold in their pans. We even found small garnets which were quite a hit as well.

We then learned how to set up a sluice box and get the right 'drop' for the most efficient water flow and velocity and we ran a little material through the sluice and everyone got to see a little gold show up in the black mat.

All in all, everyone was quite pleased with the demonstration and everyone learned a lot. When I left, there were still a few people working in the creek. Remember to patronize the Tymkovich Meat Market as a thank you to those folks for allowing us the access to the Creek from their business.



Sue's Sluice Box

Georgetown Loop & Lebanon Silver Mine Tour

When: Saturday, September 24

Meeting Time & Place: 9:30am (1st Train departs 10:00am) Devil's Gate Station

Where: Georgetown, CO

Directions: From Denver: Take I-70 West towards Georgetown, Take Exit 228, Turn right at the Visitor's Center and follow the signs to Loop Drive from Argentine Street or Sixth Street to Devil's Gate Parking area.

Cost: Adults-Train & Mine Tour \$32.95 (Train Only \$24.95) Children (3 to 15 yrs.) Train & Mine Tour \$23.95 (Train only \$16.95)

The Train

The Loop takes you between Georgetown & Silver Plume, over 2 miles apart, the tracks scale an elevation of 640 feet over mountainous terrain, requiring trestles, cuts, fills, loops, and curves totaling 3.1 miles of narrow gauge track. We sit in open-air cars, for excellent viewing and pictures.

Lebanon Silver Mine

The tour is a walking tour, located at the halfway point on the railroad. The tour takes you 500 feet into a mine tunnel bored in the 1870s. Your guide will point out rich veins of silver and tell you about early-day mining. The mine is usually relatively dry and a constant 44° F. The tour also includes visits to the manager's office, the miners change room and the tool shed. Hard Hats are provided. Please wear warm clothing and sturdy walking shoes. Bring your cameras!

NOTE: There are other departure times for those who are running late and can't make the 1st train.

THEN

Colorado School of Mines Geology Museum Tour

Saturday, October 22nd

Meeting Time: 9:30am (Tour starts at 10:00am Sharp)

Where: Corner of 13th and Maple Street, Golden, CO

Cost: FREE

Enjoy a two hour tour of the CSM Geology Museum. Our tour guide will be Bruce Geller, Geology Museum Director. Bruce promises to give our group a "special tour". If anyone has not visited this museum, you are in for a treat. The exhibits include: Gold & Silver Displays, Mining Artifacts, Minerals of Colorado, Colorado Mining Heritage, Gemstones – Rough & Cut, World Minerals, and Fossils.

Any Questions: Come and talk with me or call 413-668-6008.

I hope you can attend these great educational and fascinating tours!!!!!!!

Sluicin' Sue

GPR Metal Detecting Outing by Jim Long

On Saturday August 6, a dozen or so Club members managed to get

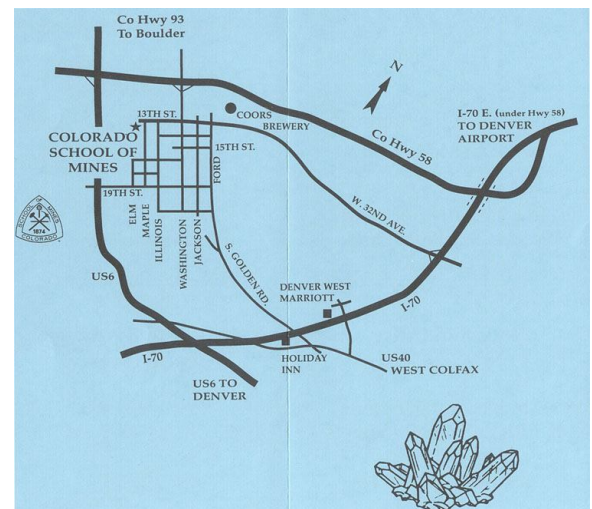
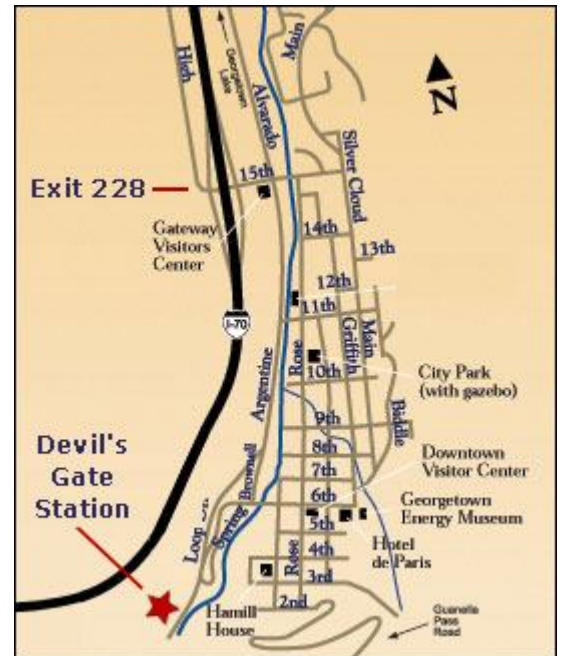



Gold Prospectors of the Rockies Page 7

together at the Northwest Open Spaces in Northglenn to do a little metal detecting. This particular outing did not have any planted targets or anything and was intended to just be a fun thing to do as a group for the day.

Most everyone who attended managed to find something. There were many coins found to include some Canadian and Mexican. Terry Weatherly probably found the most coins and also found a beautiful ring as well as a really cool green Hawaiian key chain turtle can opener fob. JJ Long found several pendants and a very old Schrade pocket knife. Chuck Cowan found quite a few coins as well.

The weather was clear and pretty hot and water was definitely an essential, but a good time was had by all.

Club Picnic a Big Success by Jim Long

The Annual Club Picnic was held on August 20 at 11am at the Lions Park in Golden, Colorado. About 45 to 50 members turned out for the event.

President Long did the barbequing of burgers, brats, dogs, and some chicken. The Club provided the meats, drinks, condiments and plates and utensils and many of the members brought a side dish to add to the kitty. It was a fine feast indeed.

Don Bray brought some concentrates that he had obtained the day before on an excursion with President Long and while we ate, he ran them through his mini-sluice. I think everyone was surprised to see how much gold we are getting out of our little spot since the high water has gone down. You could see a lot of garnets in his black sand as well. Thanks for showing off the good stuff, Don. I think everybody really enjoyed seeing that demonstration. I saw Chuck Cowan doing a little metal detecting and I'm sure he found something. He usually does. And a big thank you to Andy Doll for taking pictures of the event as well.

It was great seeing everyone at the picnic and I hope everyone had as good a time as I did.

TYMKOVICH MEATS

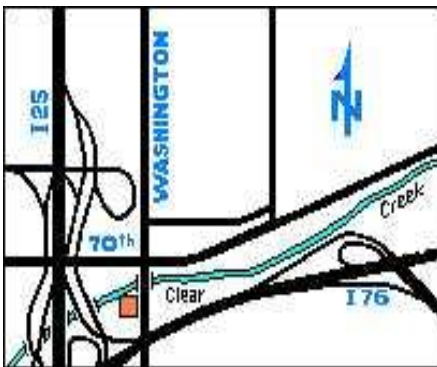

Established 1952
6911 N.
Washington St,
Denver, CO 80229
(303) 288-8655
Open Wed-Sat
9:30 to 5:30
(Closed Sun-Tue)

Colorado Nuggets Gold Nuggets from Around the World



P.O. Box 964—Evergreen, CO 80437-0964
(303) 674-6573

E-mail: sales@coloradonuggets.com

www.coloradonuggets.com

VISA MASTERCARD DISCOVER

GOLD - N - DETECTORS

A METAL DETECTING &
PROSPECTING
CENTER



(303) 2786622
802 Washington Ave.
Golden, CO 80401

"Denver area's award winning hobby store, where we do what we sell."

- Metal Detectors
- High Bankers
- Rock Tumblers
- Books
- Goldpans
- Dredges
- Rock Picks
- Accessories

Open 9-6 Monday through Saturday

VISA, MasterCard, Discover

PLACE YOUR AD HERE

PLACE
STAMP
HERE

The Gold Nugget

Gold Prospectors of the Rockies
PO Box 621988
Littleton, CO 80162-1988

ADVERTISING IN THE GOLD NUGGET

Commercial Ads

- 3.6" x 2.0" Two Column Inches (Business Card Size)..... \$6
- 3.6" x 4.3" Four Column Inches..... \$12
- 7.5" x 4.3" Eight Column Inches (Horizontal)..... \$24
- 3.6" x 9.3" Nine Column Inches (Vertical)..... \$24
- 7.5" x 9.3" Eighteen Column Inches (Full Page)..... \$48

For information to publish your "Ad" in The Gold Nugget, please contact the Editor. **COPY DEADLINE** is due to the editor by the 25th of the month for publication in the following months' issue of the Newsletter.

Contact the GPR President

(Layout Design Subject To Additional Cost)



Coming Announcements and Special Events for October 2011

(WMMI - Western Museum of Mining & Industry, 225 North Gate Blvd. Colorado Springs, CO 80921 (www.wmmi.org))

SUN	MON	TUE	WED	THU	FRI	SAT
		WMMI - Halloween Scavenger Hunt Haunted Mines Farmers' Market Family Exploration Day See their web site for schedules				1
2	3			6	7 Newsletter Advert/Article Copy Deadline	8
9	10 Columbus Day	11	12	13	14	15
16	17 (Observed) Bosses Day	18	19 GPR Club Meeting	20	21	22 School of Mines Museum Tour
23/30 23 - Mother- In-Law Day	24/31 31 - Halloween	25	26	27	29	20